

AVIEW Eyewear Guide for Optometrists

A handy **HOW TO** guide to adding prescription lenses to AVIEW frames. The glasses are uniquely designed to help people see the colors of the world. Learn more at www.aview.com

AVIEW Frames Are Unique!

Our innovative design allows for prescription lenses AND interchangeable colored sunglass lenses

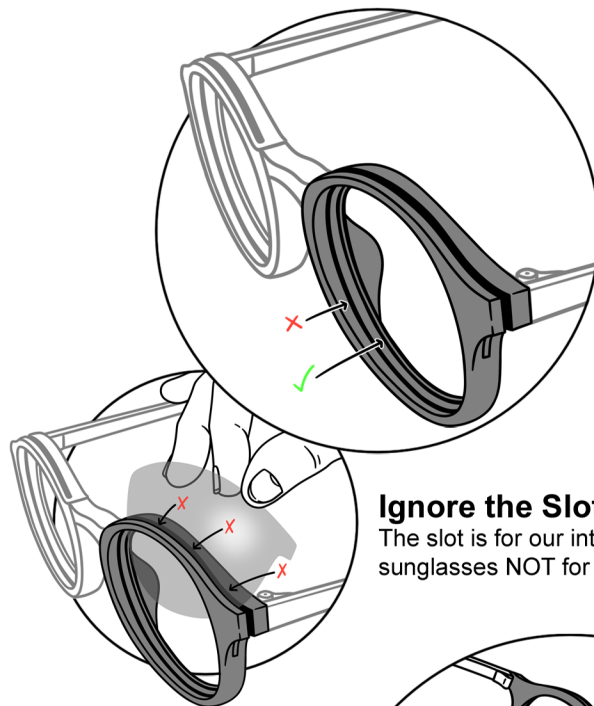

Two Sets of Lens Grooves
Prescription Lenses Will Be Placed in the **Back Groove**

The **Front Groove** is for AVIEW Interchangeable Sunglass Lenses

Ignore the Slot On Top

The slot is for our interchangeable sunglasses NOT for prescription lenses

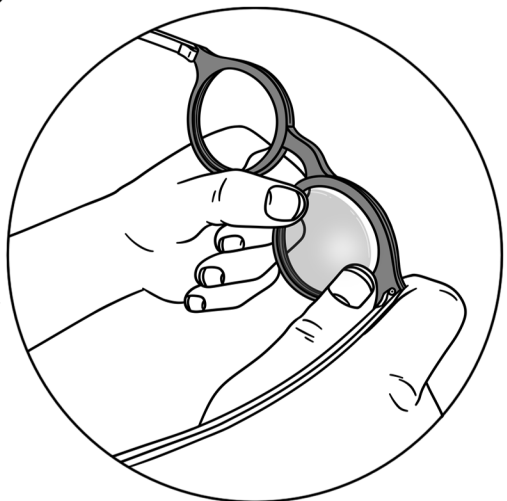

From the Back

Easiest way to pop in and out RX lenses is from the back

+/- Diopter Maximum



We recommend only prescriptions up to +/- 2 diopters

Aspheric Lenses are Best

Flatter the better



Reach out with Questions!

If you have any questions, please reach out to us! info@aview.com